

# C700 Sliding Glass Door Frame Assembly Instructions

1

# C700 Frame Assembly Disclaimers

**ADVISORIES AND DISCLAIMERS:** Fully read and follow instructions to ensure proper frame assembly for C700 sliding glass door product. Frame Assembly is not a “do-it-yourself” project and should be installed only by experienced, qualified, and where required, licensed installation professionals.

Read this entire document before proceeding with the assembly of Milgard’s products. These instructions address only the installation process for panels into Milgard sliding door products. Read and fully understand ALL manufacturer’s instructions prior to beginning the assembly. Fully follow the applicable Milgard Installation Recommendation for the door. Failure to follow the applicable installation instructions may affect the ability to assemble and operate the door, as well as coverage under the applicable Milgard express limited warranty.

These instructions are to be used only with products specifically ordered with the panel orientation addressed in these instructions. Products must be identified as such on the order documents so the manufacturing plant can properly prepare the products for field assembly. If the doors do not arrive prepared for use with this set of instructions, do not move forward with installation and contact your Milgard representative.

This is a finished product that must be protected before, during and after installation to prevent damage to the glass, frame, finish and hardware. All component parts, including door panels, should be stored in a dry location that is protected from the elements.

Doors requiring field assembly will be delivered with a kit containing the items that should be used when assembling the panels and hardware. Milgard’s products are rated for performance based on the specific items and fasteners included with this kit. Any deviation from these guidelines or substitutions/use of parts not provided with the kit could affect the performance of the product.

Proper panel installation and operation requires appropriate support and securing of fasteners into rough opening framing members. This has the potential to impact the flashing and water management systems at a product opening. Consult the responsible system supplier or responsible owner, architect and/or builder to ensure that support and fastening of the door is effective and in compliance with applicable laws, site requirements and building codes.

Inspect the panel and door frame thoroughly before beginning the assembly process. Ensure all product and hardware options are included with the product. Inspect and report any product or panel damage or other concerns to your Milgard representative prior to moving forward with installation.

# C700 Frame Assembly Disclaimers

**ADVISORIES AND DISCLAIMERS (continued):** Jobsite and worker protections are recommended and may be required. Follow all manufacturers' instructions for appropriate and safe use of protective equipment, tools, materials, hardware and site protections necessary for assembly of the products. Use caution when handling glass. Broken or cracked glass can cause serious injury.

It is the responsibility of the installation contractor to consult and establish appropriate safety and health practices and determine the applicability of regulatory limitations prior to commencing installation. Do not work alone and use safe lifting techniques. Two or more people may be required to lift. Use a reasonable amount of people with enough strength to lift, carry and install to avoid injury and/or damage to the Product.

It is the sole responsibility of the owner, architect, and/or builder to select the correct products and ensure that installation is in compliance with applicable laws, site requirements, and building codes. Failure to follow these recommendations, local requirements, or good building practices may affect the availability of remedies under Milgard's warranty.

Entry doors of any kind include elements specifically intended to address security and safety concerns. Ensure appropriate glass selection, hardware systems, and presence of security elements (e.g., antilift blocks) are presents on the product before moving forward with installation. Proper assembly and adjustment of security and safety devices must be observed prior to finalizing panel installation.

# C700 SGD Frame Assembly

## Parts Checklist

FRAME ASSEMBLY BILL OF MATERIALS			
ITEM NO.	MILGARD P/N	DESCRIPTION	QTY.
1	PX5016XX	SGD SILL W/ WEATHERSTRIP & WEEP GATES & SILL JOIN BAR INSERTED	1
2	PX5016XX	SGD JAMB W/ WEATHERSTRIP INSERTED	2
3	PX5017XX	SGD HEAD W/ WEATHERSTRIP INSERTED	1
4	IM3113NC	SILL TO JAMB CORNER KEY	2
5	IM3114NC	HEAD TO JAMB CORNER KEY RIGHT	1
6	IM3115NC	HEAD TO JAMB CORNER KEY LEFT	1
7	FA0315XX	#8x1/2 PH FH SMS	28
8	SE0034CL	PECORA SEALANT	4

Other Tools required:

- Caulk Gun
- Rubber Mallet
- Level Bar

# C700 SGD Frame Assembly

## Parts Checklist

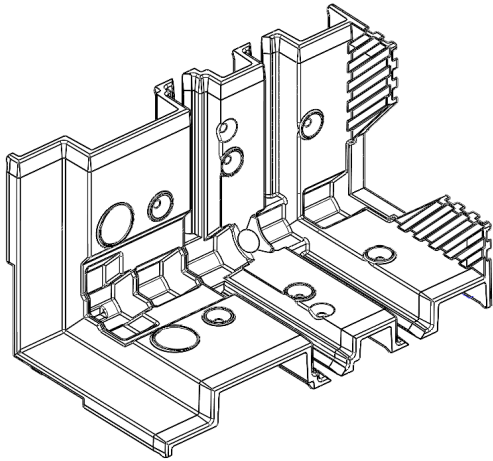

#4: Sill to Jamb Corner Key  
IM3113  
2x

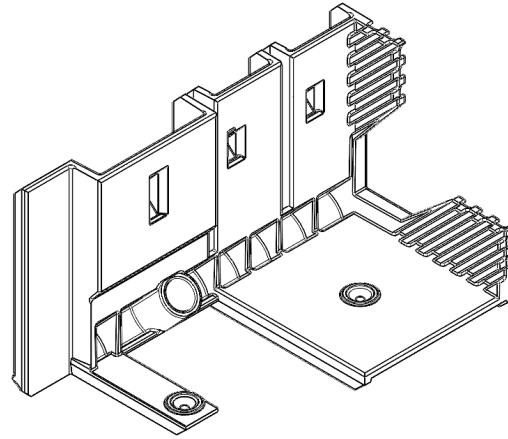

#5: Head to jamb Corner Key – Right  
IM3114

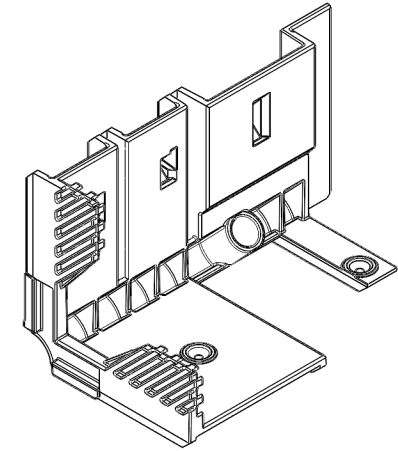

#5: Head to jamb Corner Key – Left  
IM3115

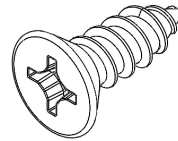

#7: #8x1/2 PH FH SMS  
FA0315XX  
28x

# C700 SGD Frame Assembly

## Accessory Parts Checklist

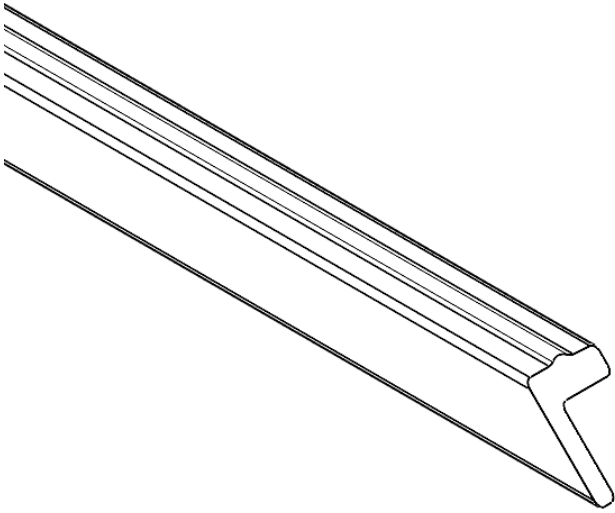

Stucco Key  
EX7302XX

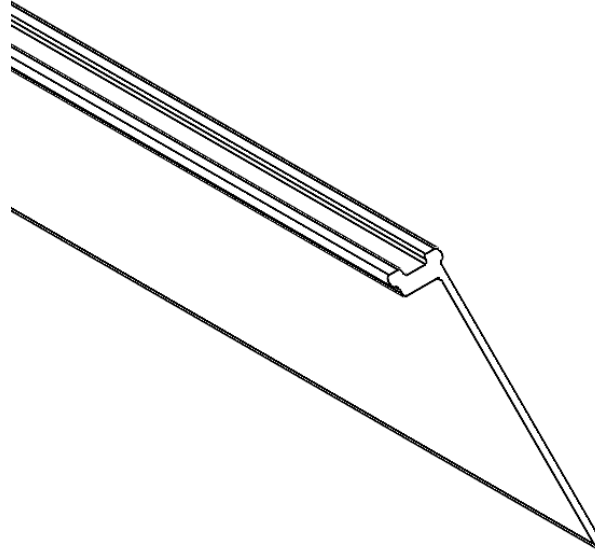

Nail Fin  
VA5084AMIWH

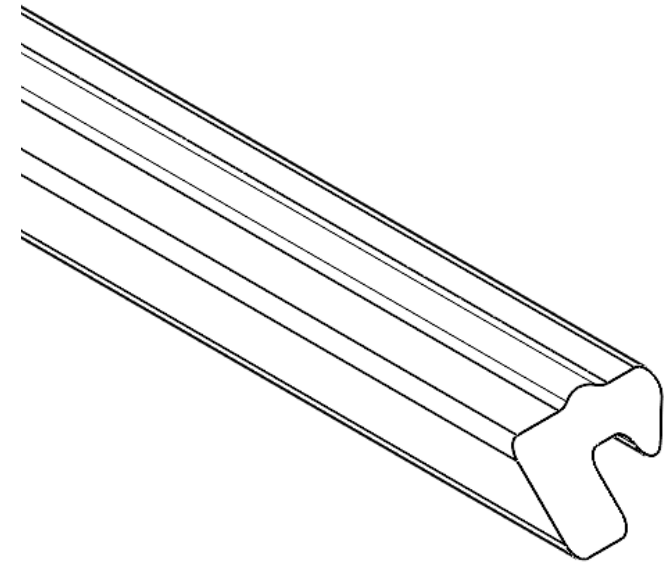

Groove Filler  
EX7303XX

# C700 SGD Frame Assembly

## Accessory Parts Checklist

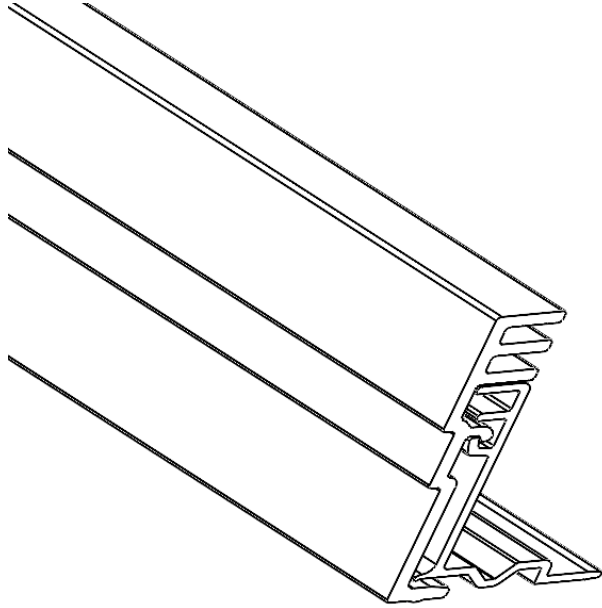

2-1/4" Wide Z-bar  
EX7315XX  
EX7317XX

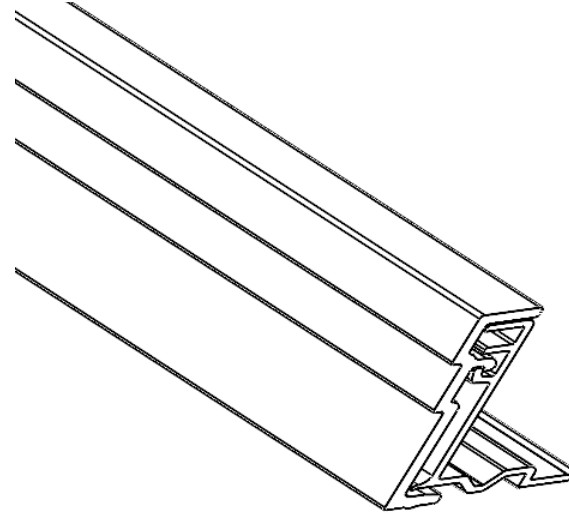

1-3/4" Standard Z-bar  
EX7315XX  
EX7316XX

# C700 SGD Frame Assembly Instructions

## Frame Assembly Layout

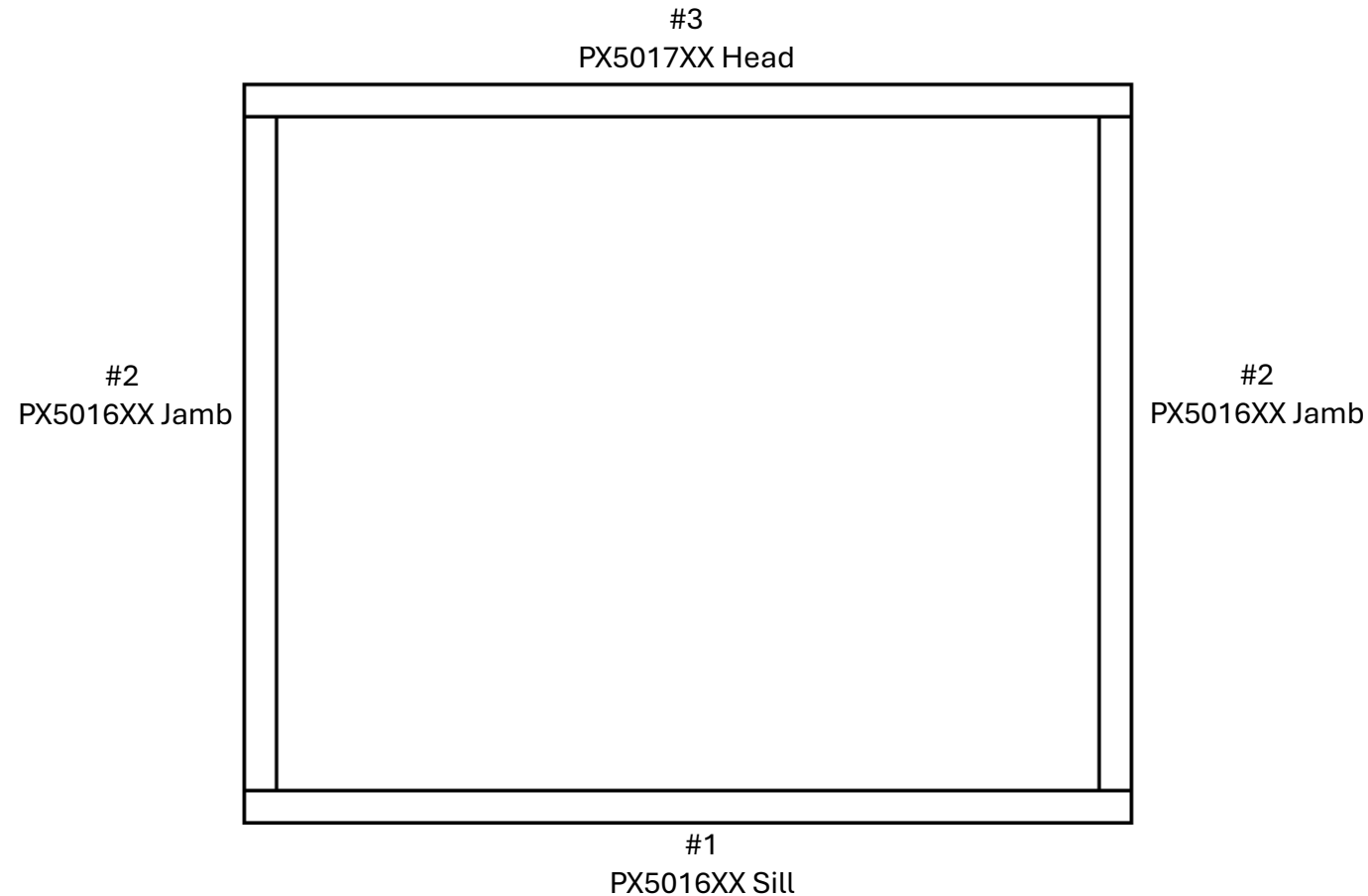



# C700 SGD Frame Assembly Instructions

## Step 1: Sill to Jamb Assembly – Jamb Identification & Orientation

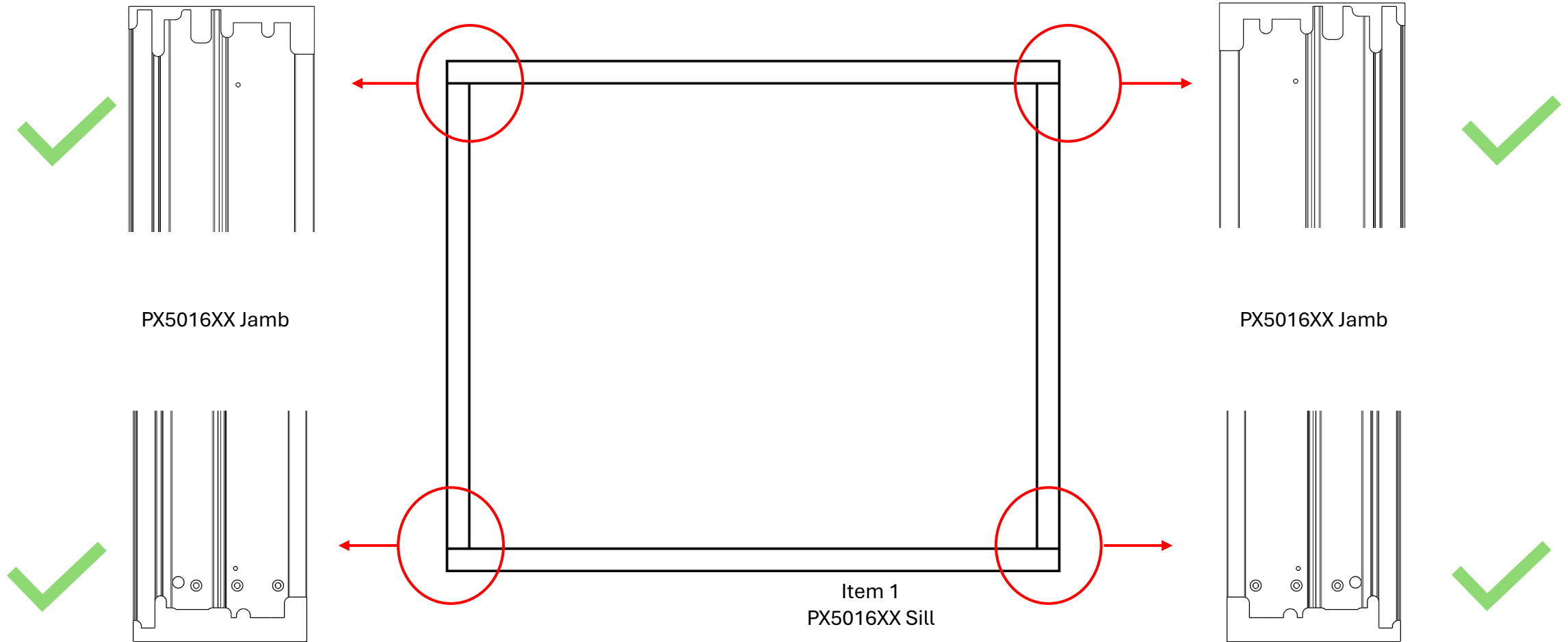

# C700 SGD Frame Assembly Instructions

## Step 1: Sill to Jamb Assembly

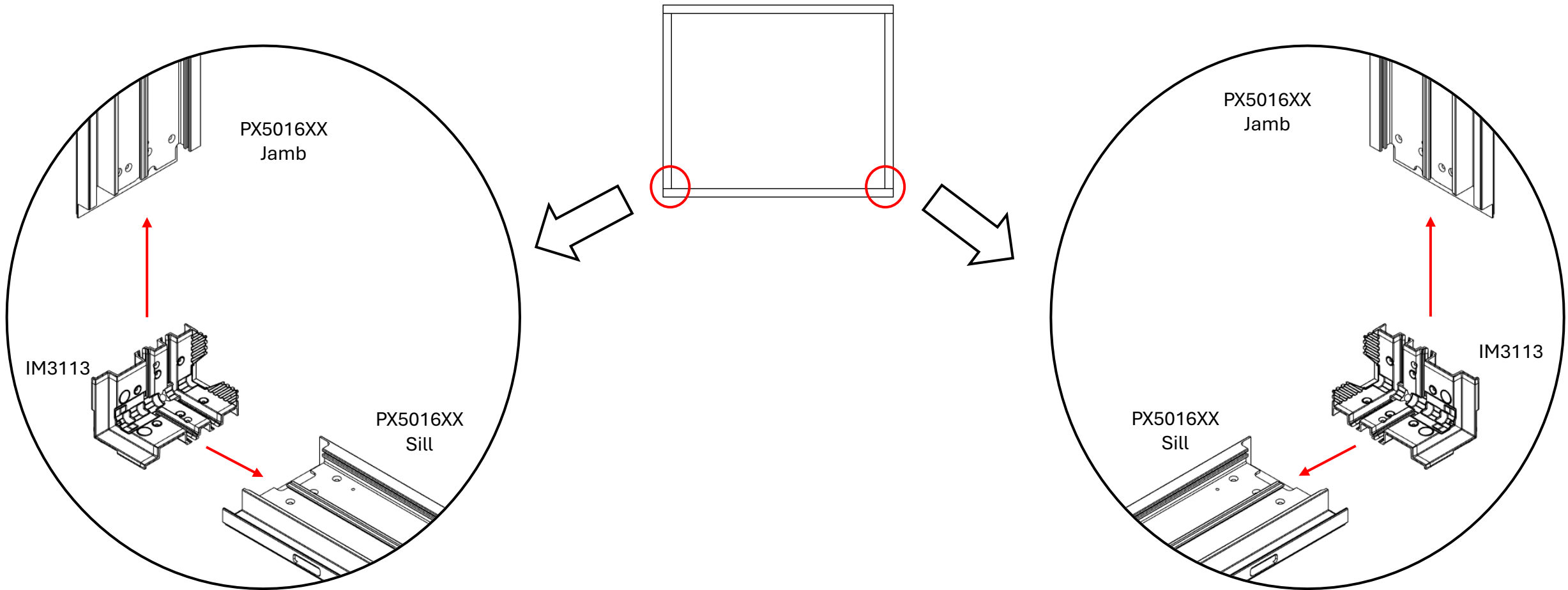

# C700 SGD Frame Assembly Instructions

## Step 1: Sill to Jamb Assembly

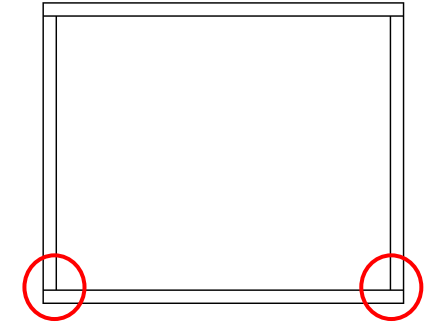
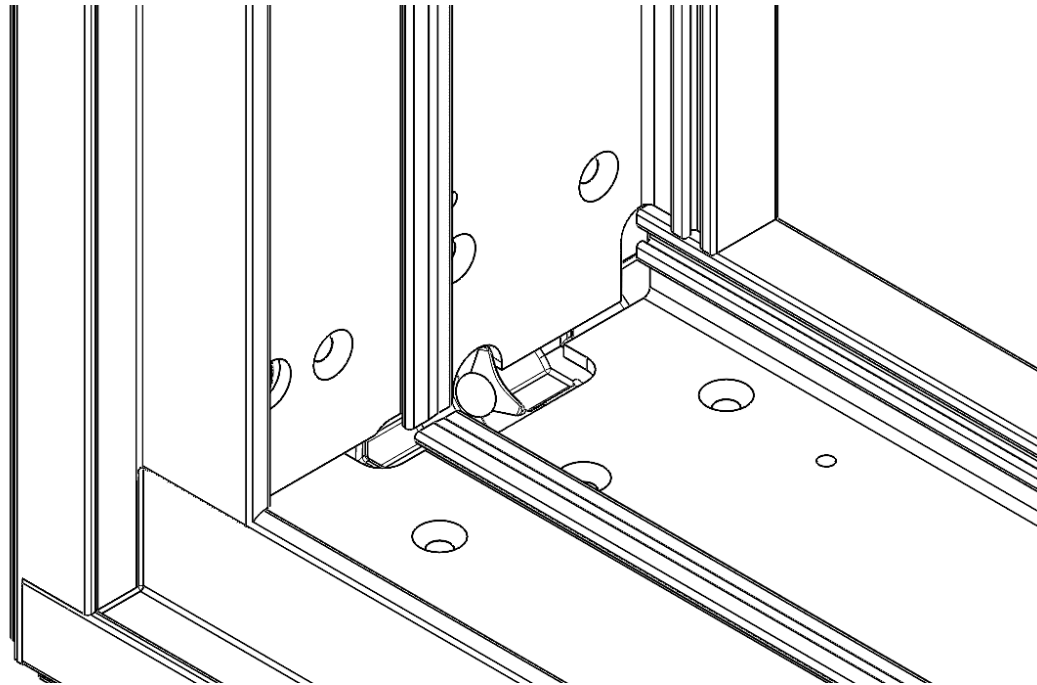

**Note:** Assemble jamb to sill flush as shown. Diagram for 1 side shown. Both left and right sides must be assembled as shown.

# C700 SGD Frame Assembly Instructions

## Step 1: Sill to Jamb Assembly

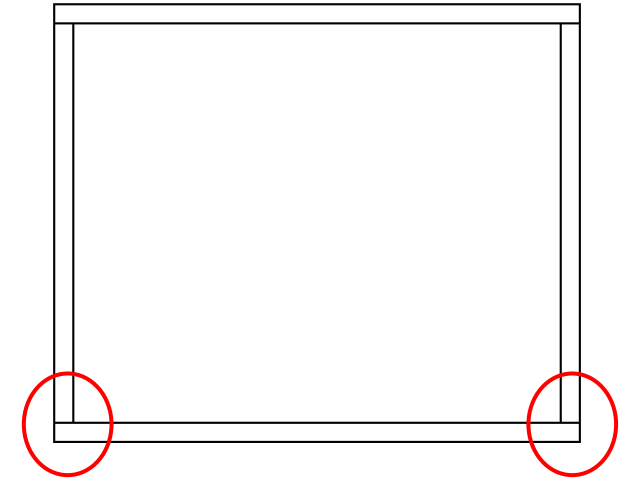
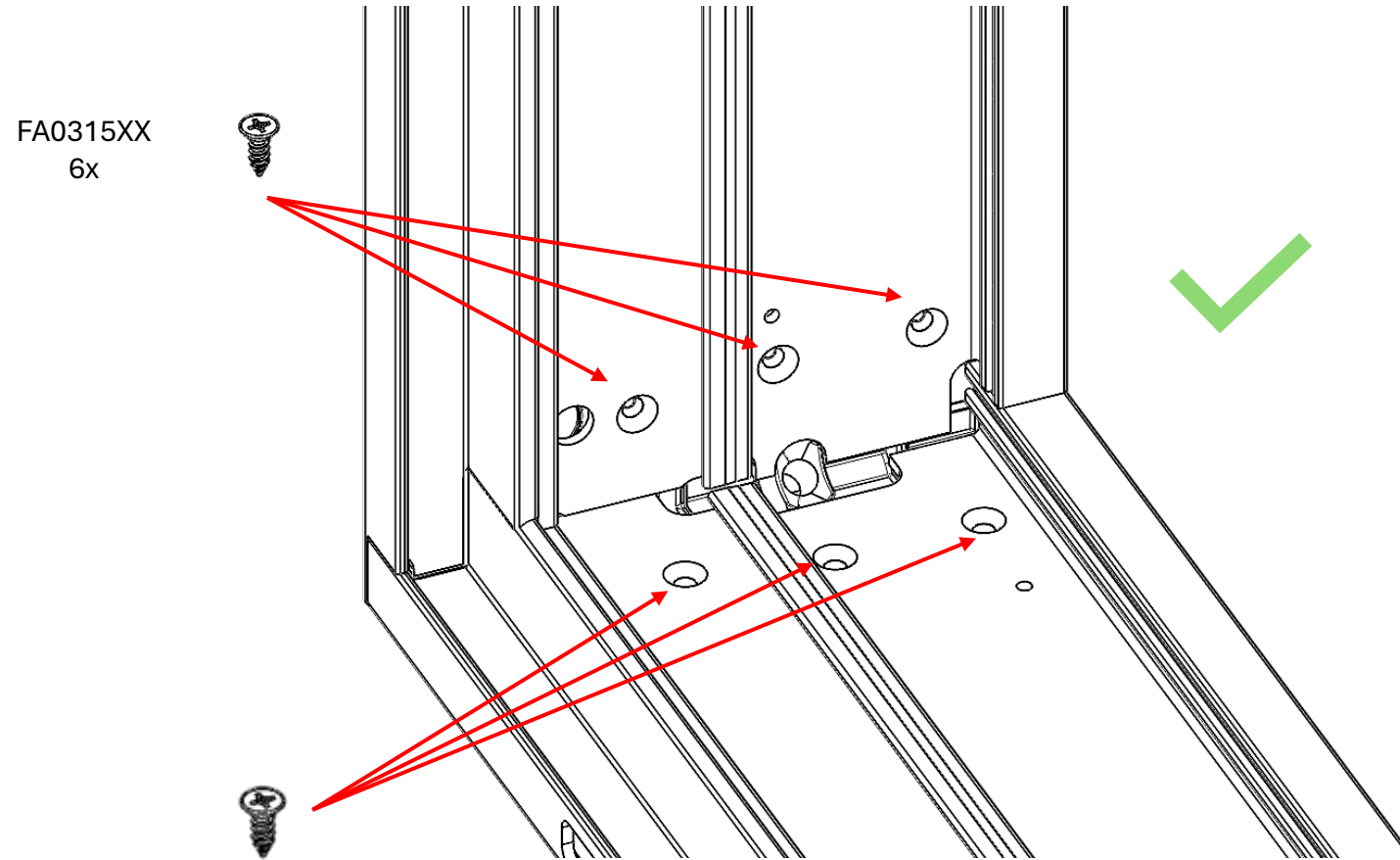

**Note:** Diagram for 1 side shown. Both left and right sides must be assembled as shown.

# C700 SGD Frame Assembly Instructions

## Step 1: Sill to Jamb Assembly

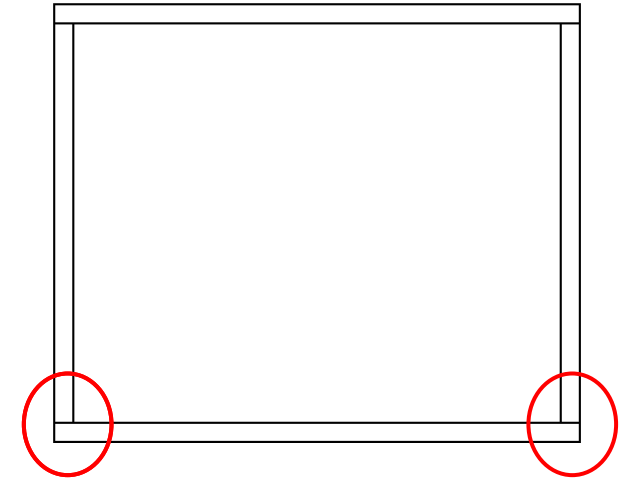
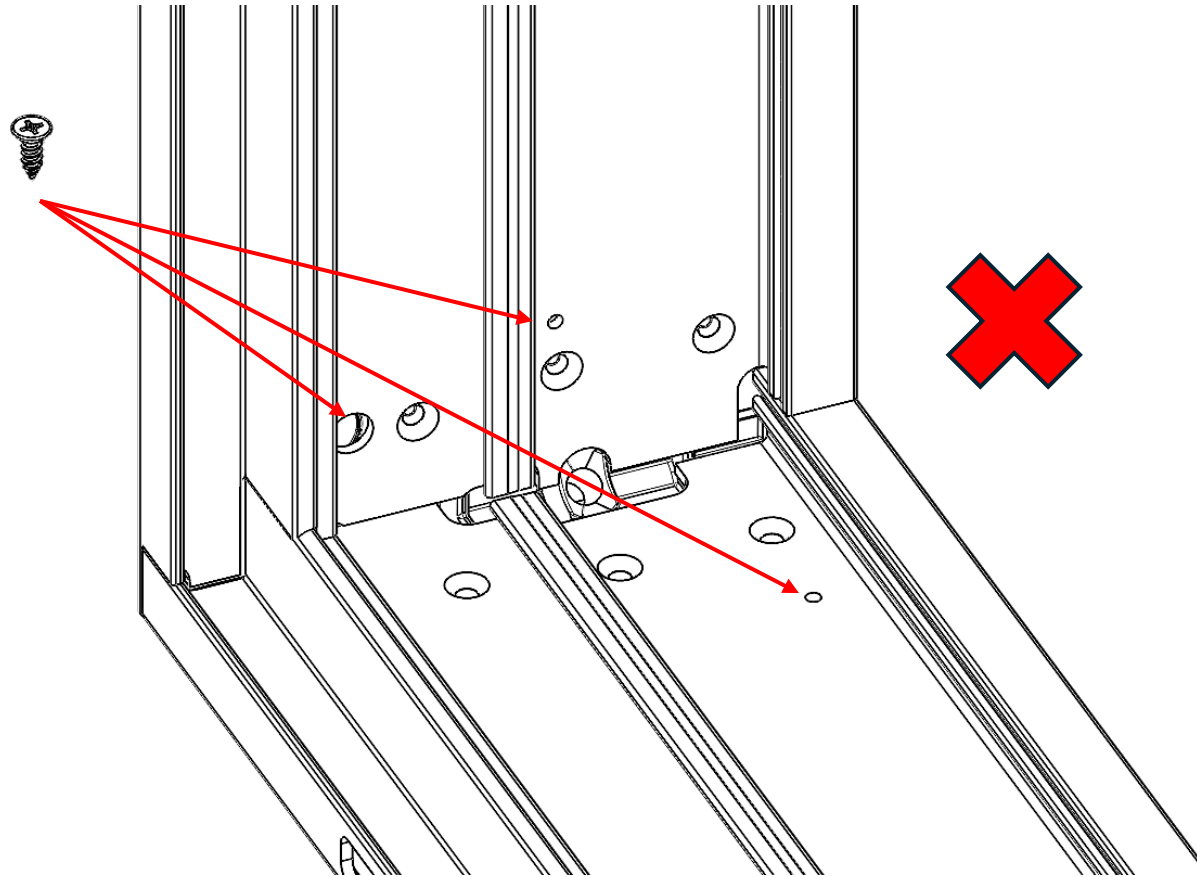

**Note:** Do not use screws in the holes shown. Only use screws in the designated countersunk holes per page 10.

# C700 SGD Frame Assembly Instructions

## Step 2: Head to Jamb Assembly

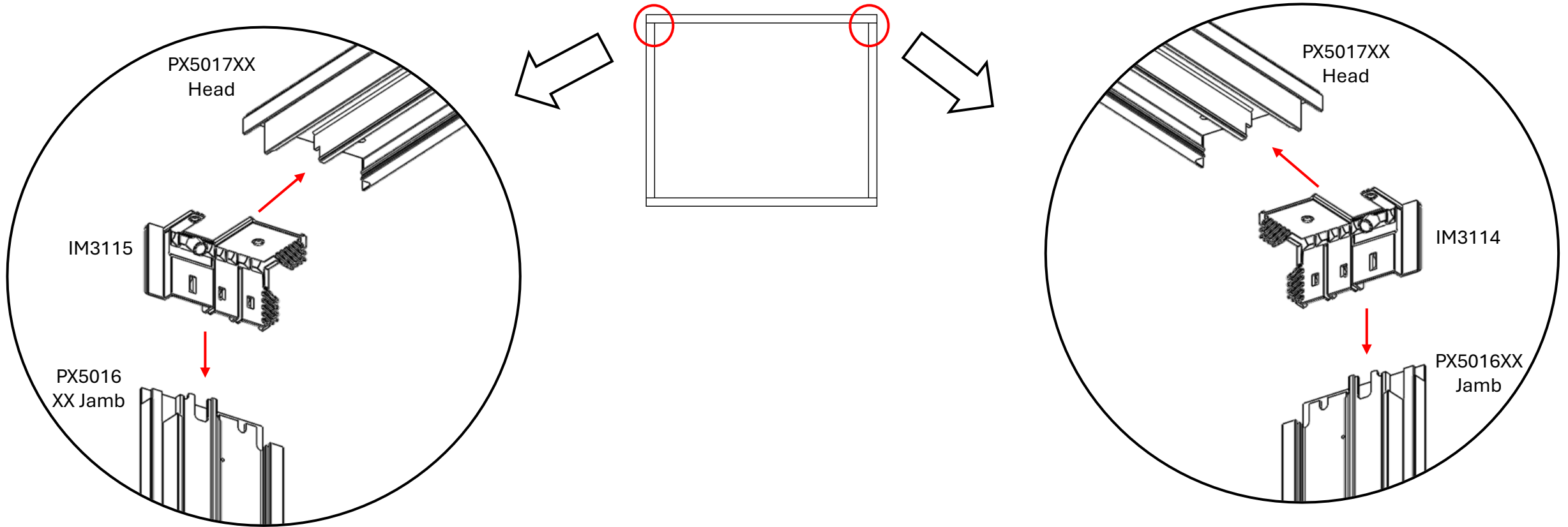

# C700 SGD Frame Assembly Instructions

## Step 2: Head to Jamb Assembly

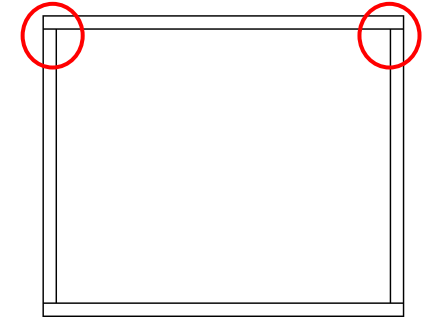
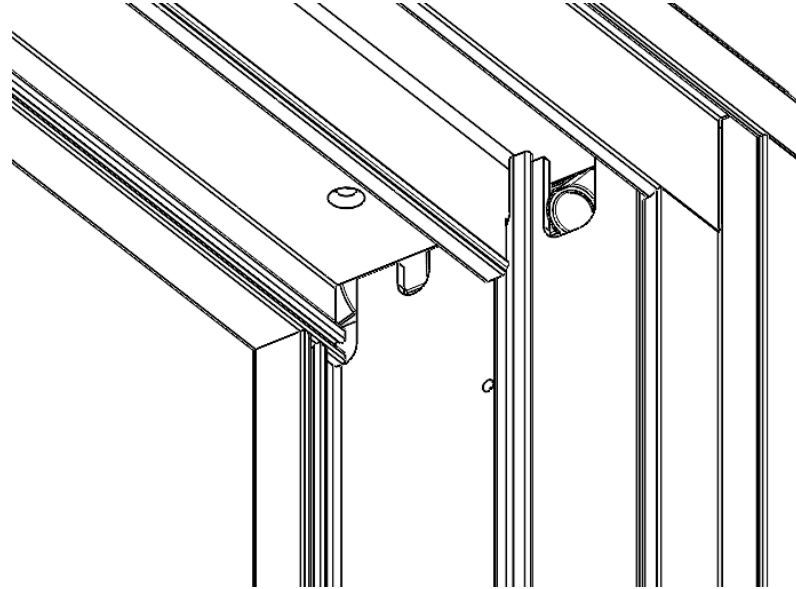

**Note:** Assemble jamb to head flush as shown. Diagram for 1 side shown. Both left and right sides must be assembled as shown.

# C700 SGD Frame Assembly Instructions

## Step 2: Head to Jamb Assembly

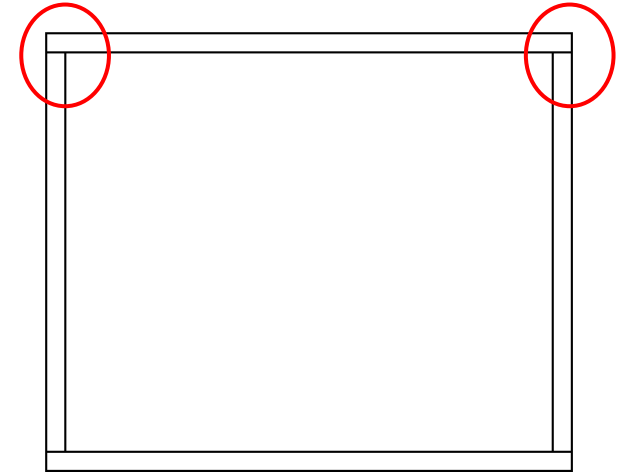
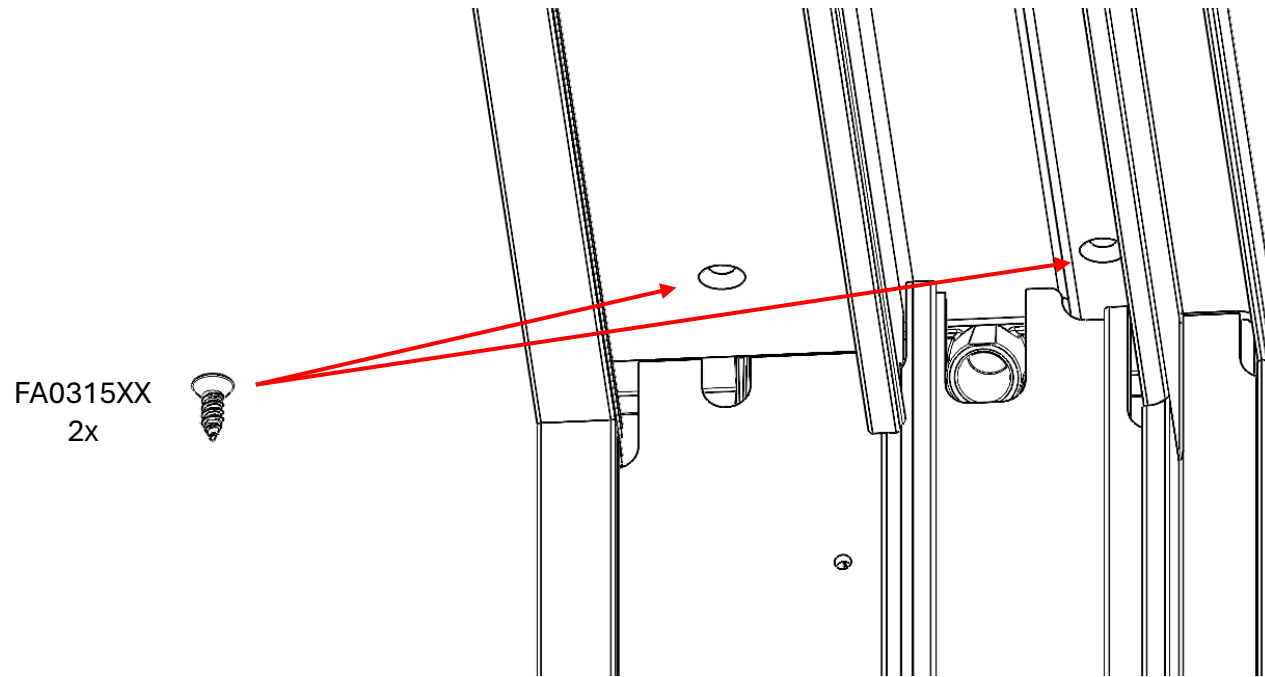

**Note:** Diagram for 1 side shown.  
Both left and right sides must be  
assembled as shown.



# C700 SGD Frame Assembly Instructions

## Step 2: Head to Jamb Assembly

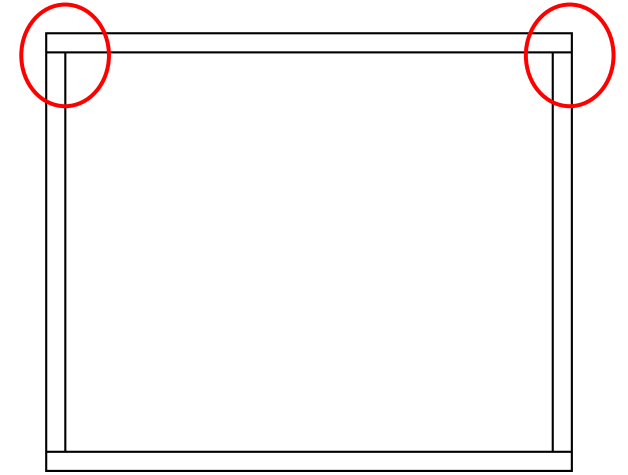
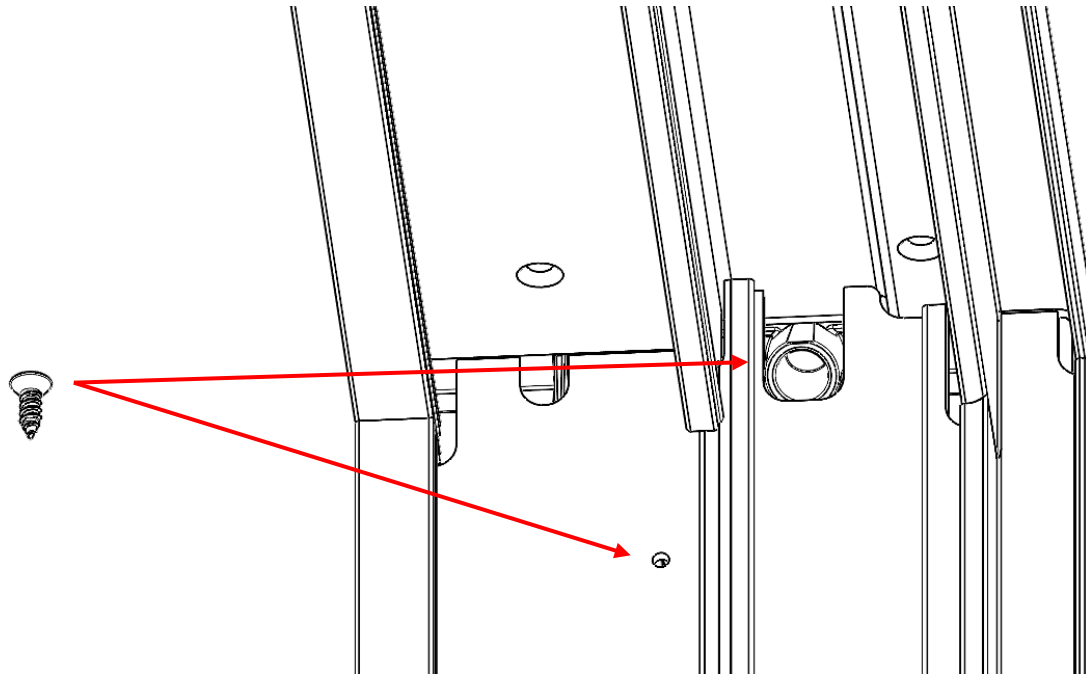

**Note:** Do not use screws in the holes shown. Only use screws in the designated countersunk holes per page 10.

# C700 SGD Frame Assembly Instructions

## Step 2: Head to Jamb Assembly

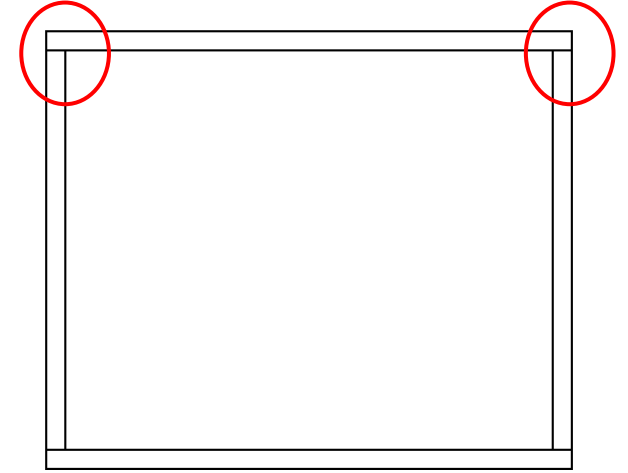
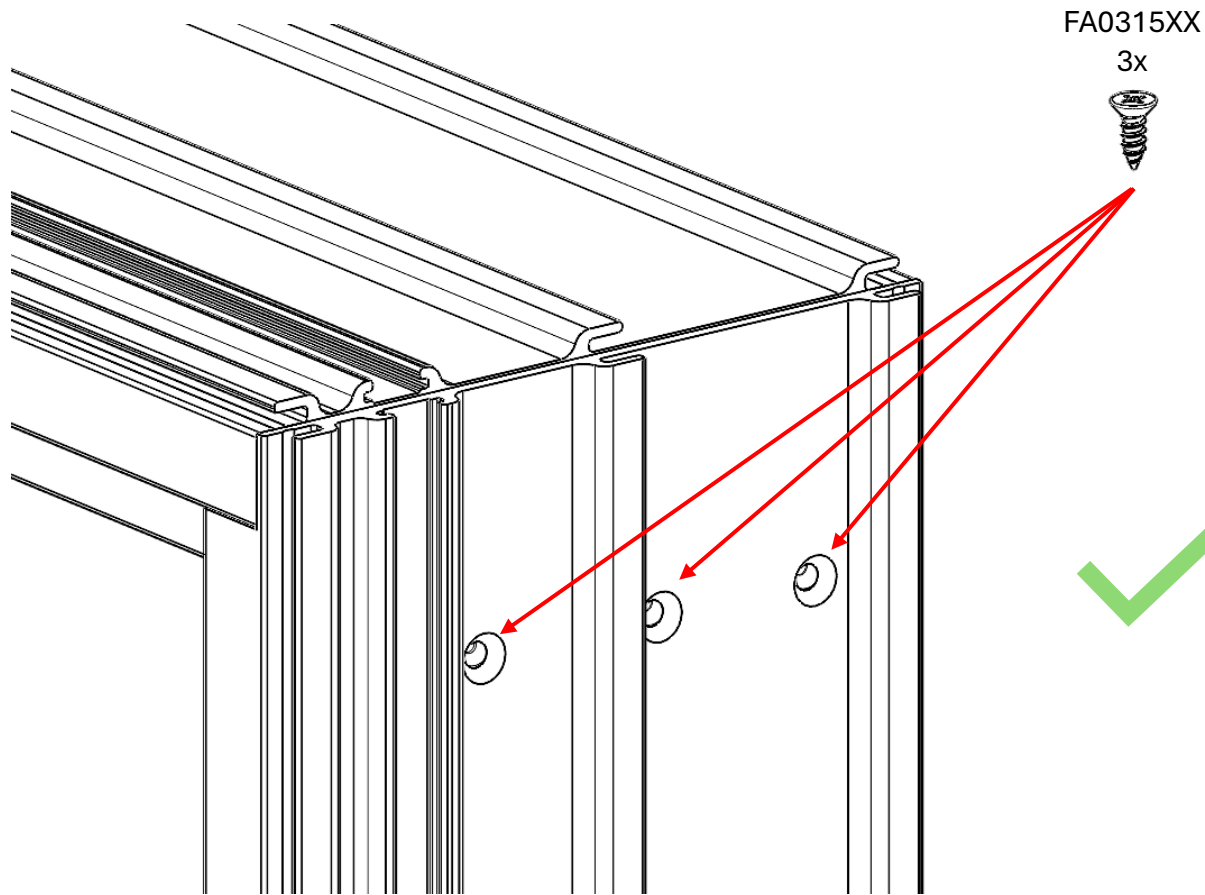

**Note:** Diagram for 1 side shown.  
Both left and right sides must be  
assembled as shown.

# C700 SGD Frame Assembly Instructions

## **Step 3: Accessory Installation – Accessory Channels**

- Identify all accessories required for your specific configuration. See diagram below for accessory channels.

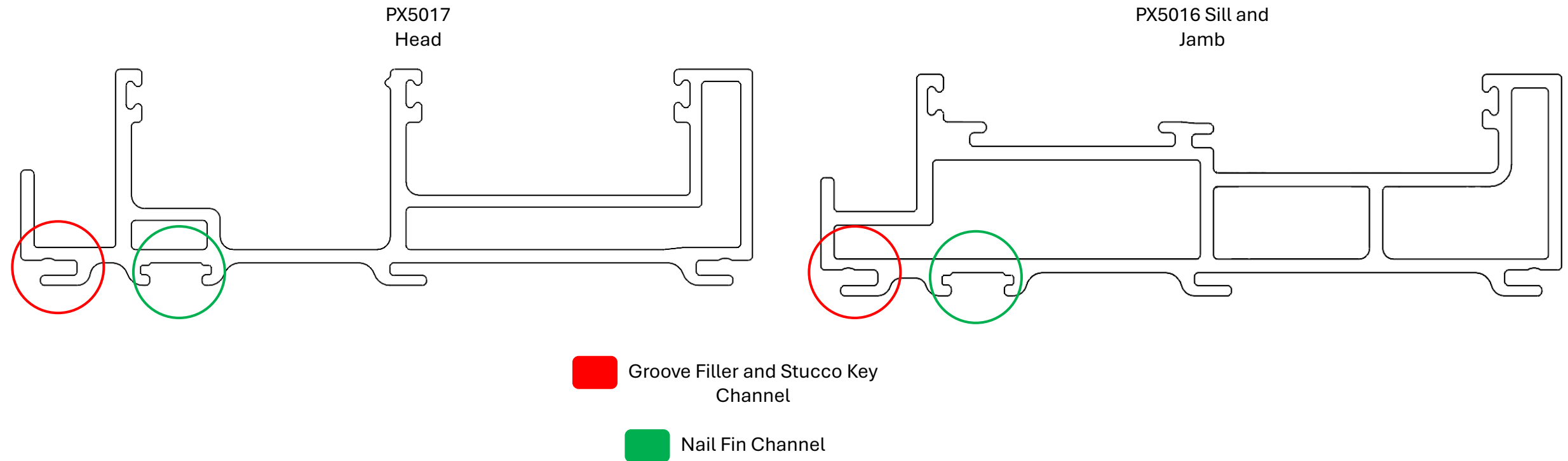

# C700 SGD Frame Assembly Instructions

## Step 3: Accessory Installation – Stucco Overall Layout

3-sided Stucco

Head: Nail Fin  
and Stucco

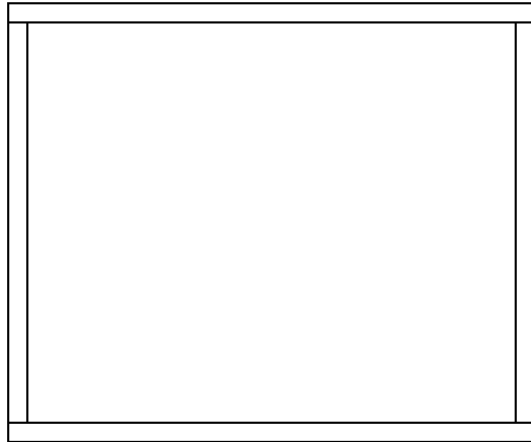

Jamb: Nail Fin  
and Stucco

Jamb: Nail Fin  
and Stucco

Sill: Groove  
Filler Only

4-sided Stucco

Head: Nail Fin  
and Stucco

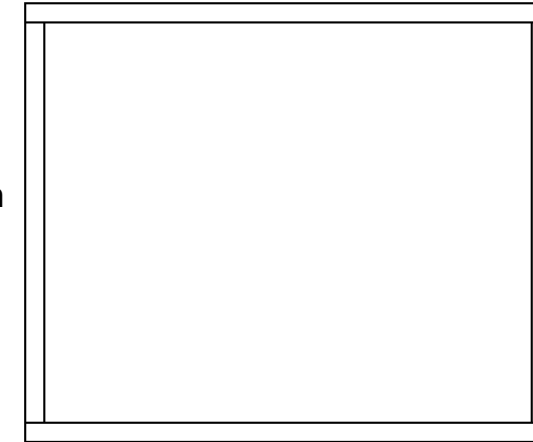

Jamb: Nail Fin  
and Stucco

Jamb: Nail Fin  
and Stucco

Sill: Nail Fin  
and Stucco

# C700 SGD Frame Assembly Instructions

## Step 3: Accessory Installation – Z-Bar Overall Layout

3-sided Z-Bar

Head: Z-Bar

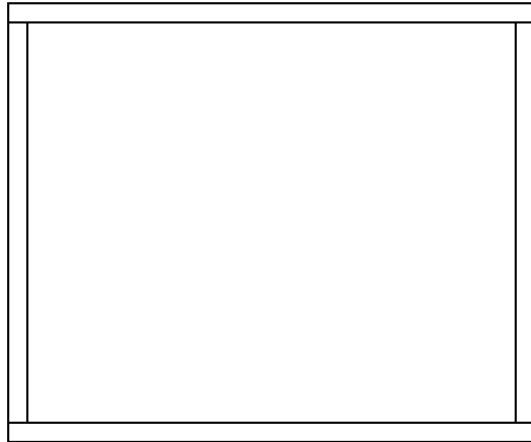

Jamb: Z-Bar

Sill: Groove  
Filler Only

4-sided Z-Bar

Head: Z-Bar

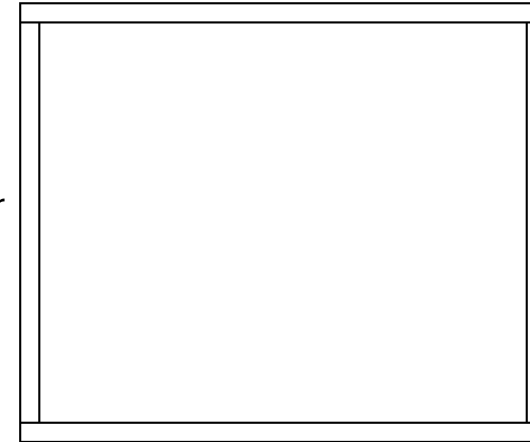

Jamb: Z-Bar

Jamb: Z-Bar

Sill: Z-Bar

# C700 SGD Frame Assembly Instructions

## Step 3: Accessory Installation – Nail Fin

- If ordered, install nail fin as shown for either 1" or 1-3/4" condition

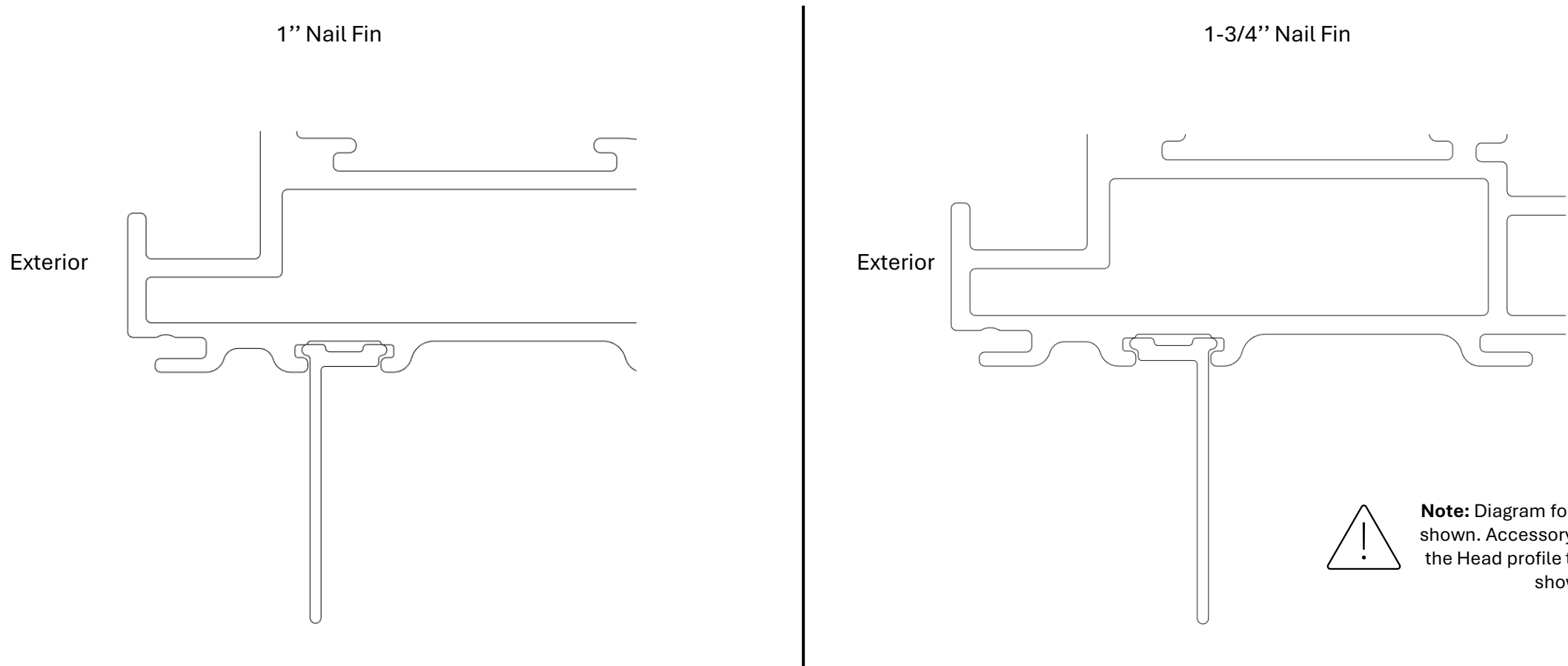

# C700 SGD Frame Assembly Instructions

## Step 3: Accessory Installation – Nail Fin Sealant

- If ordered, seal nail fin after sliding into nail fin channel using 1/8” – 1/4” size bead of Pecora sealant. Sealant is required on the entire length of the nail fin.

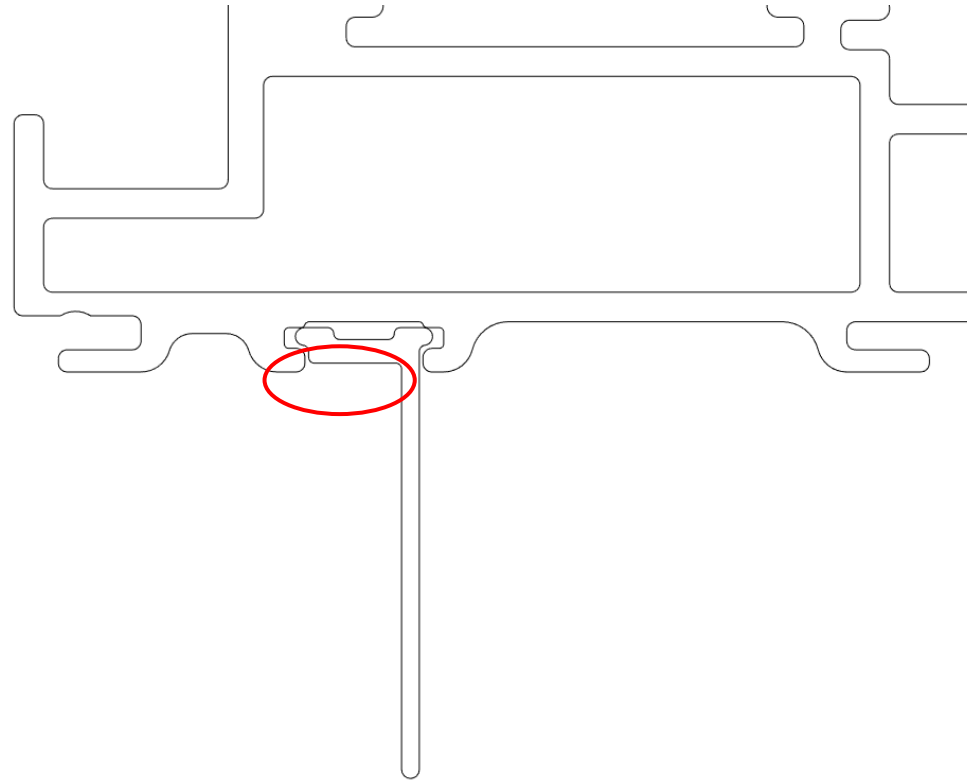

**Note:** Diagram for Sill/Jamb profile shown. Accessory is installed into the Head profile the same way as shown.

# C700 SGD Frame Assembly Instructions

## Step 3: Accessory Installation – Stucco Key and Groove Filler

- If ordered, install Stucco Key or Groove Filler as shown

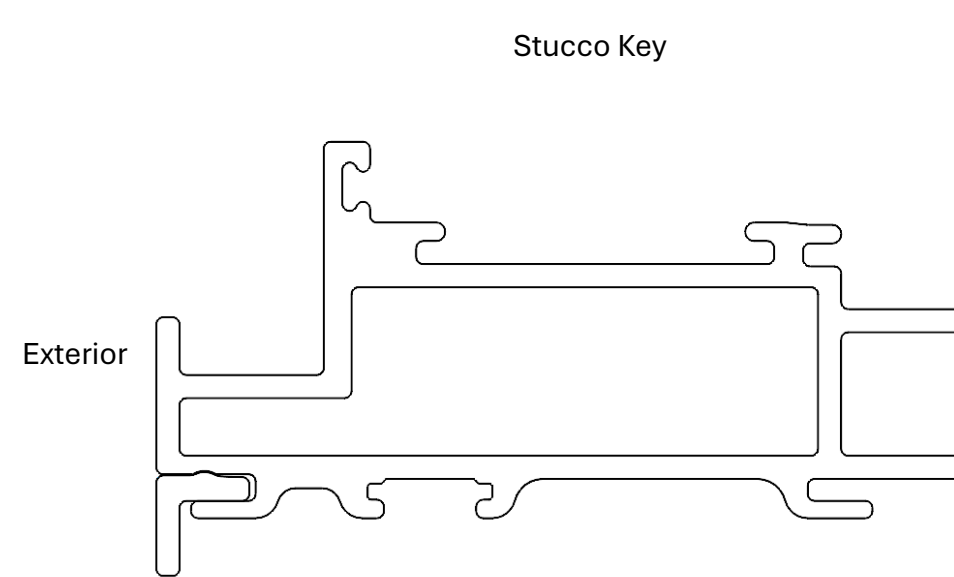
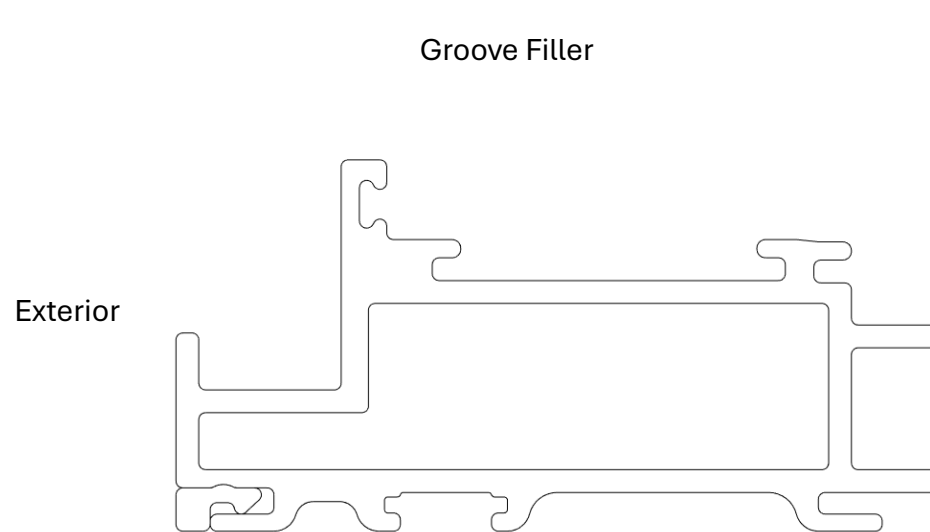

**Note:** Diagram for Sill/Jamb profile shown. Accessory is installed into the Head profile the same way as shown.



# C700 SGD Frame Assembly Instructions

## Step 3: Accessory Installation – Stucco Key and Groove Filler

- If ordered, install Z-Bar as shown

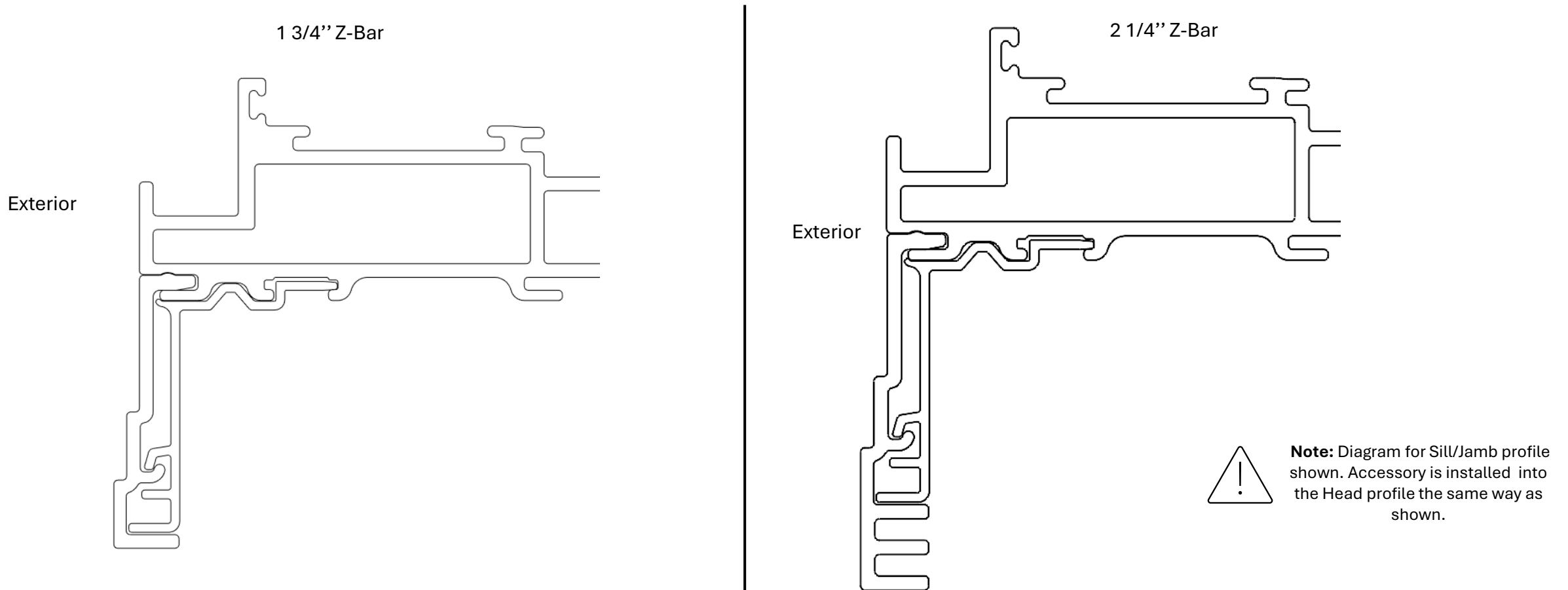

# C700 SGD Frame Assembly Instructions

## **Step 4: Frame Installation into rough opening**

- Install frame into rough opening before continuing.
- Reference the latest version of AAMA 2400 for new construction installation and AAMA 2410 for replacement installation. More information can be found in Milgard's Technical Resources website.

# C700 SGD Frame Assembly Instructions

## Step 5: Pecora Sealant Corner Injection - Sill

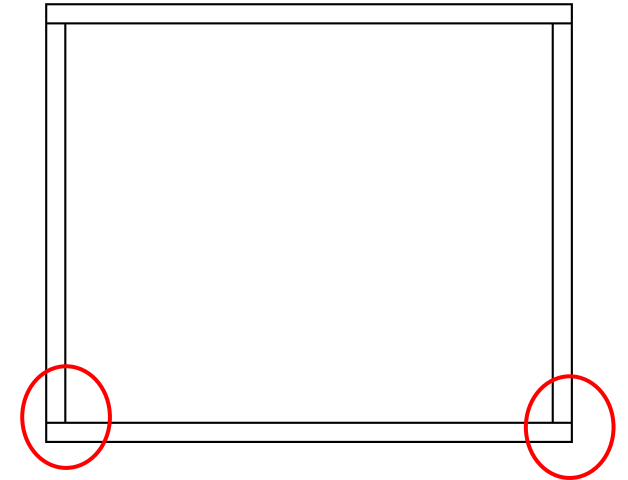
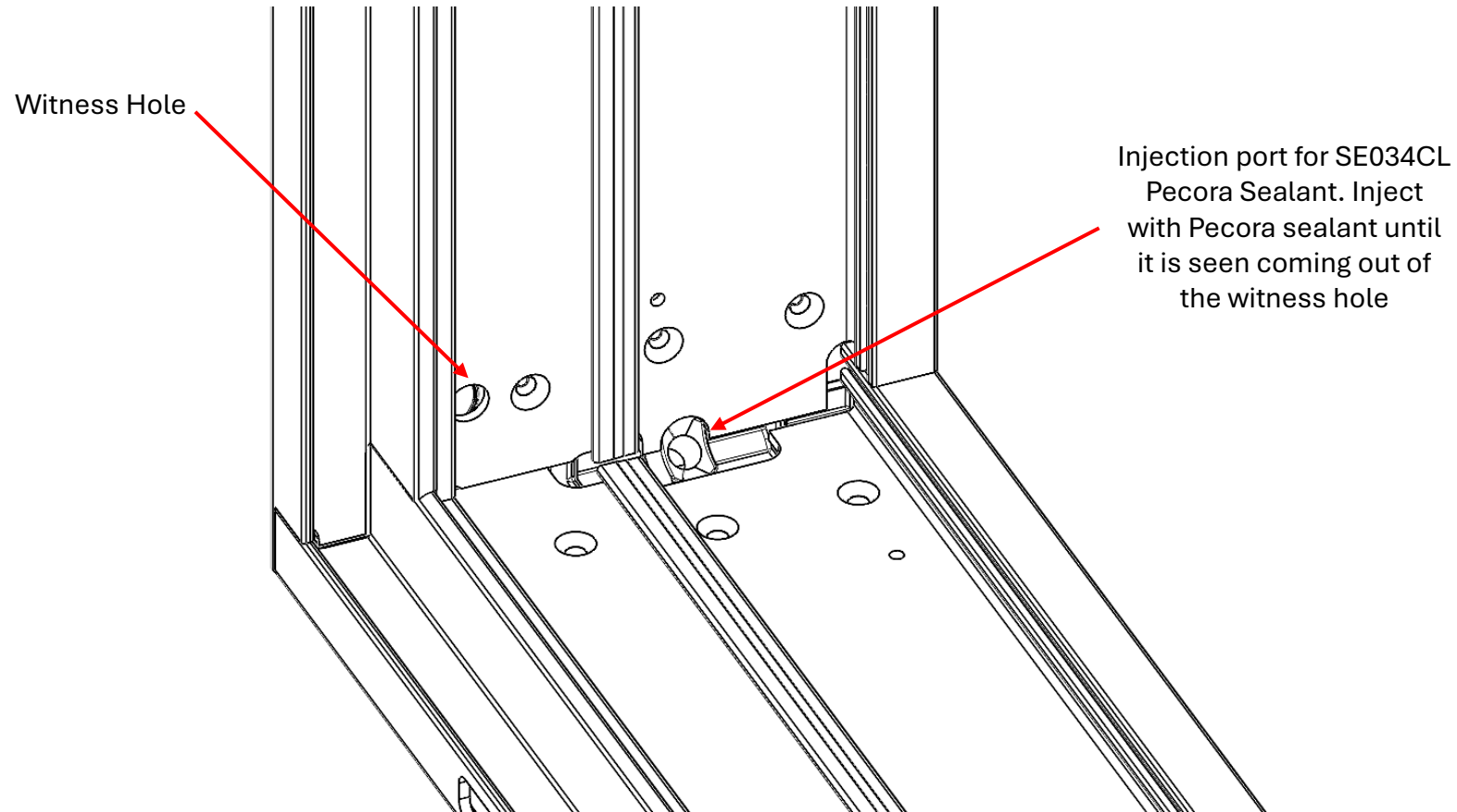

**Note:** Diagram for 1 side shown. Both left and right sides must be injected with Pecora Sealant. Refer to Pecora Sealant instructions for appropriate temperature range for sealant application.

# C700 SGD Frame Assembly Instructions

## Step 6: Pecora Sealant Corner Injection - Head

Injection port for SE034CL  
Pecora Sealant. Inject  
with Pecora sealant until  
it is seen coming out of  
the outside corners

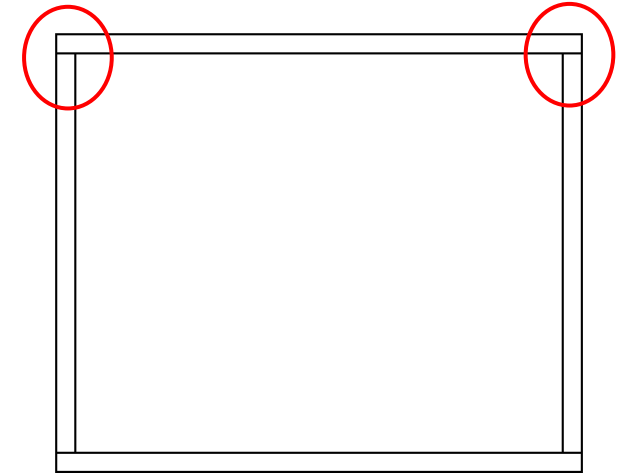
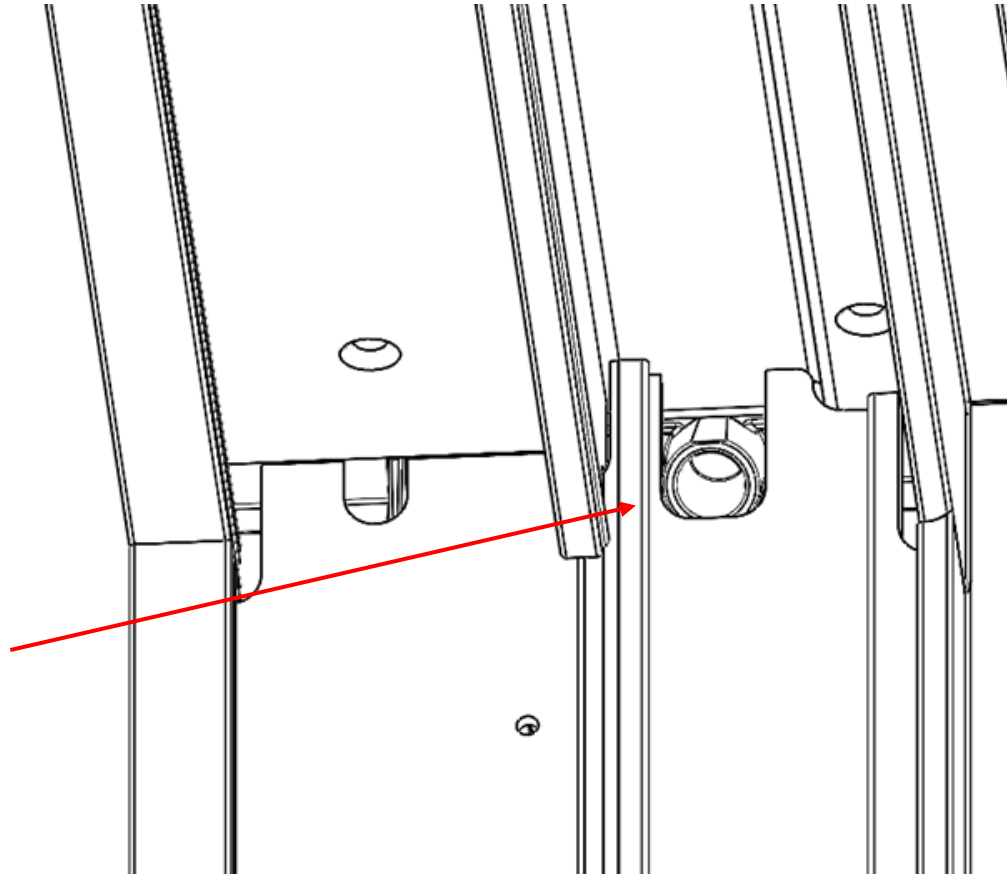

**Note:** Diagram for 1 side shown.  
Both left and right sides must be  
injected with Pecora Sealant.  
Refer to Pecora Sealant  
instructions for appropriate  
temperature range for sealant  
application.